

State Lands Commission Lease Agreement:

No. 9597.9

Quarterly Report

March 2024

Pursuant to Section 2.5 of Special Provisions, State Land Lease Agreement 9597.9 (Lease), please find the hydrologic data presented on the attached hydrographs for wells, piezometers, and flumes covered under the Lease. Historical data, when available, are included in each hydrograph.

This quarterly report includes data collected through March 2024.

Data presented in this report are **subject to update resulting from QA/QC process**. Any wells omitted no longer exist or are not monitored for various reason.

For any questions or comments, please feel free to contact Mr. Dustin Fischer via email at dustin.fischer@ladwp.com or by phone at (213) 367-2131.

Please note that:

Parcel 25 continues to have no readings due to flooding.

Parcel 31 no reading after dec 2023

Parcel 64 no reading after dec 2023

With the Brine pool flooding, monitoring at some locations is on hold, such as Parcel 25.

NO SCALE

SITE

HYDROLOGIC MONITORING
EQUIPMENT
PARCEL 1 thru PARCEL 66

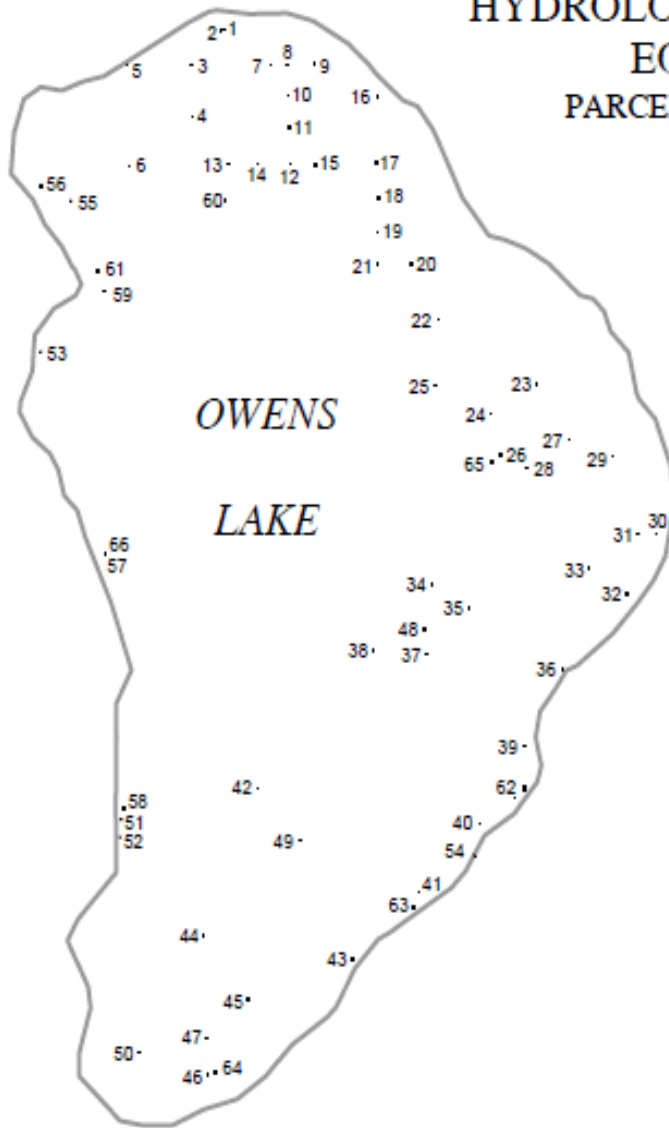

Exhibit B
A 2045
LADWP
GENERAL LEASE-
PUBLIC AGENCY USE
INYO COUNTY



This Exhibit is solely for purposes of generally defining the lease premises, is based on unverified information provided by the Lessee or other parties and is not intended to be, nor shall it be construed as, a waiver or limitation of any State interest in the subject or any other property.

TT 02/06/19

*Parcels where LADWP no longer monitors: 18 to 24 and 27

Consolidated Hydrologic Monitoring at Owens Lake

State Lands Parcels 1-66

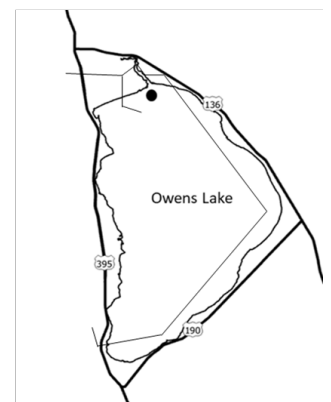
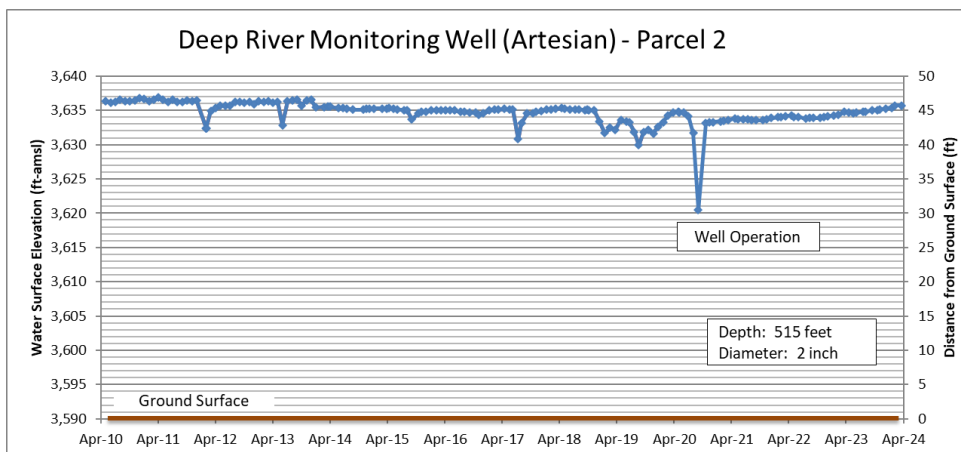
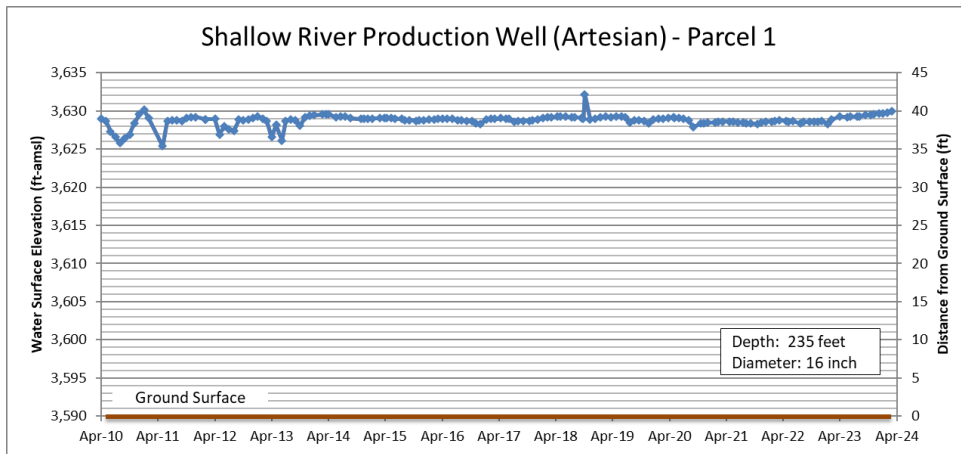
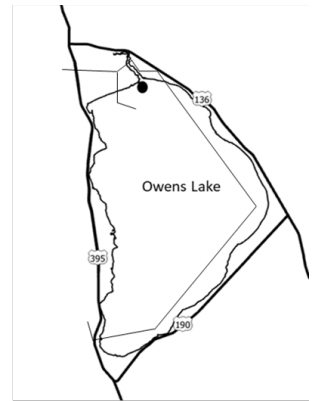
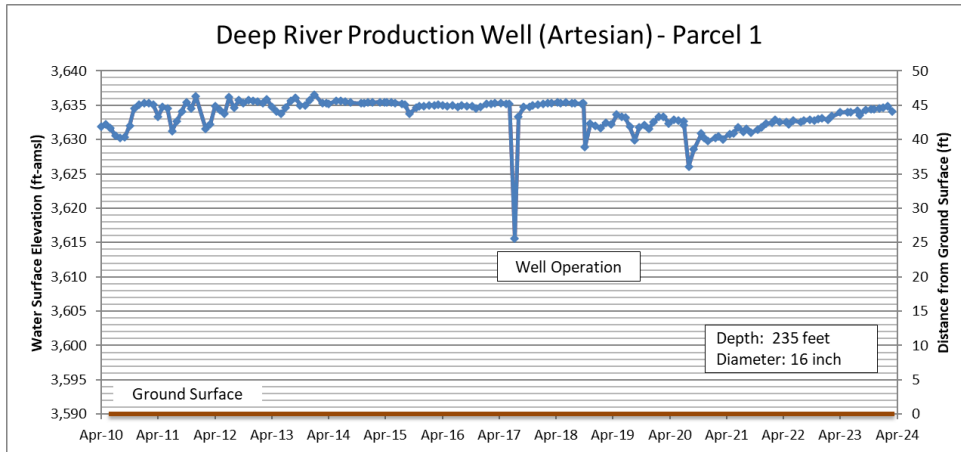

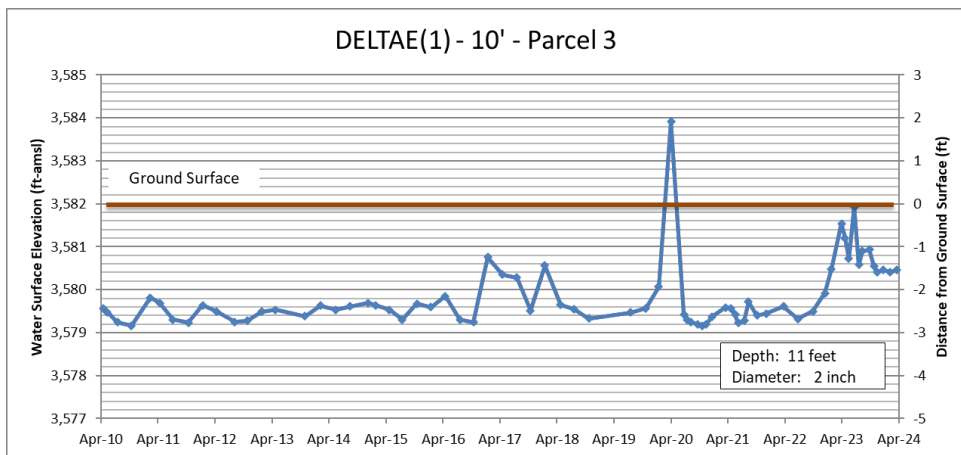
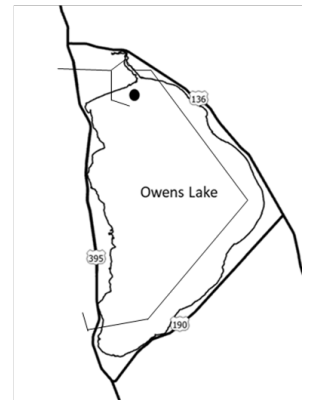
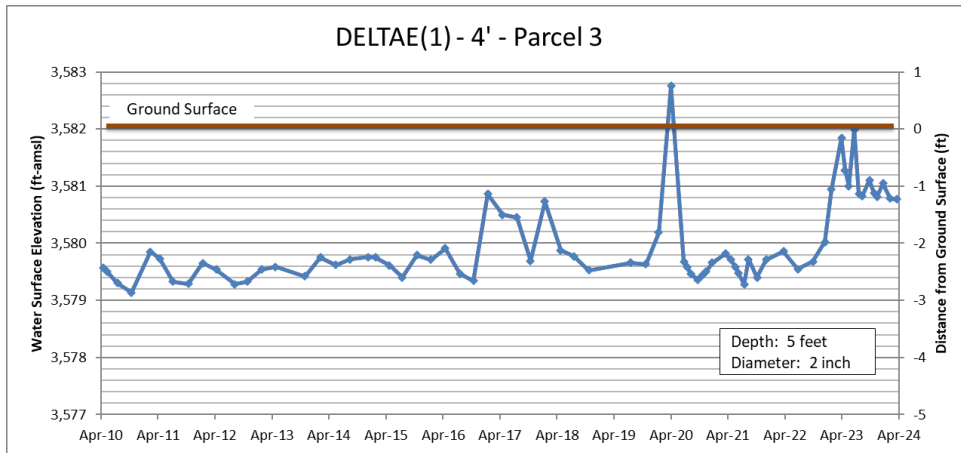
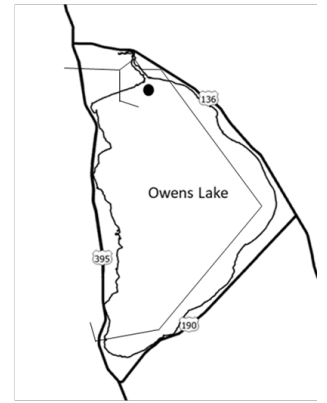
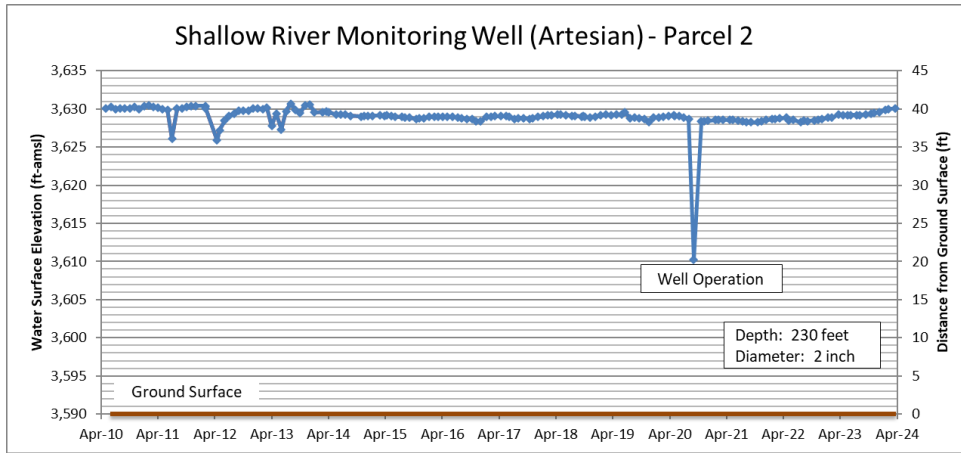

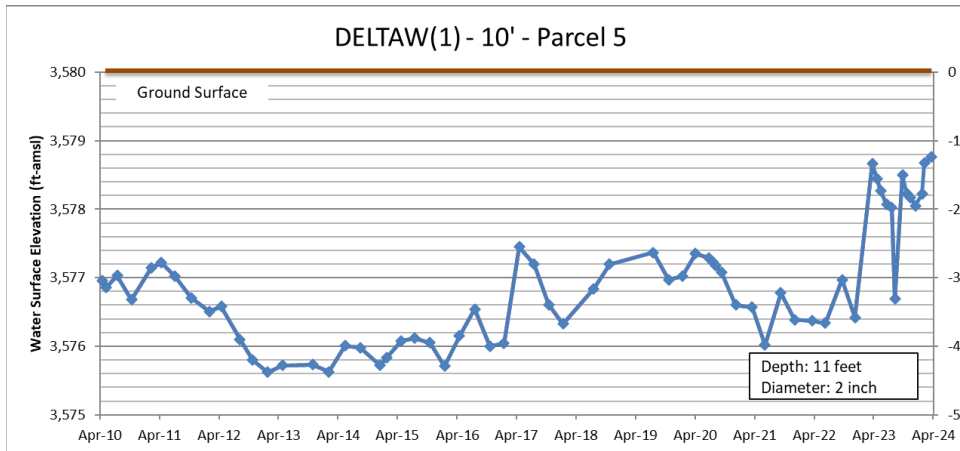
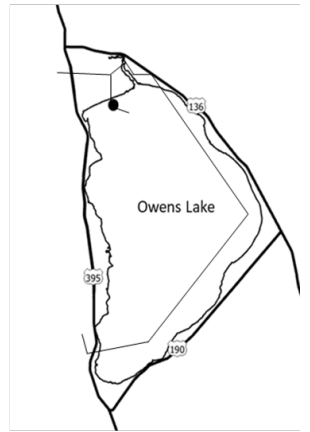
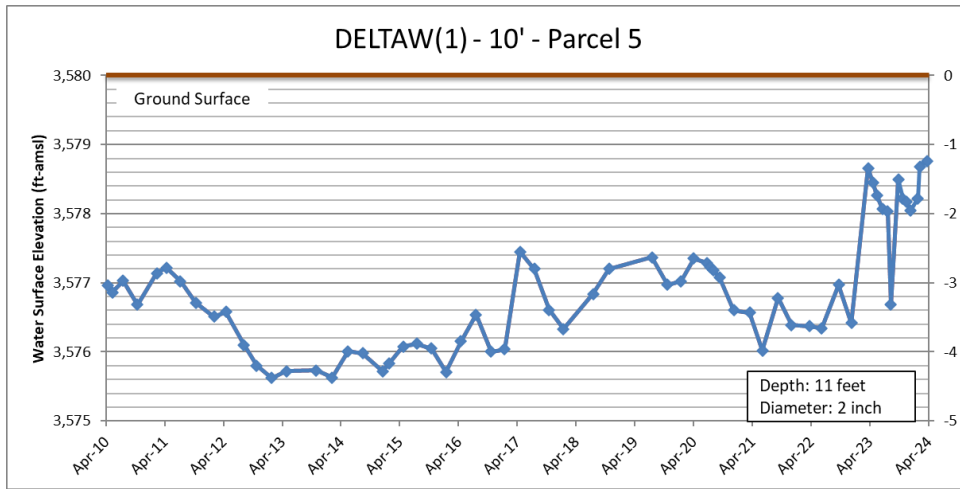
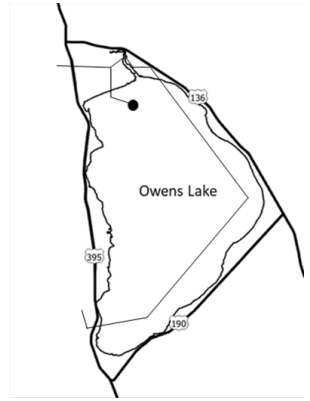
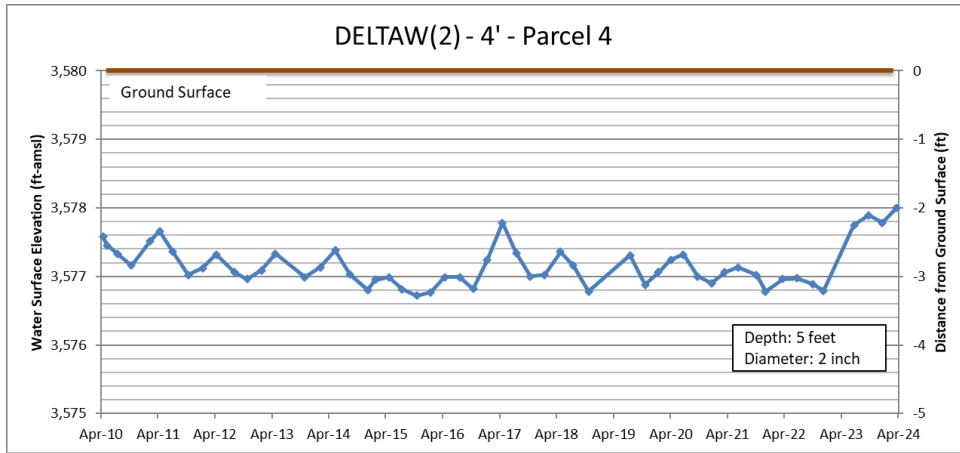

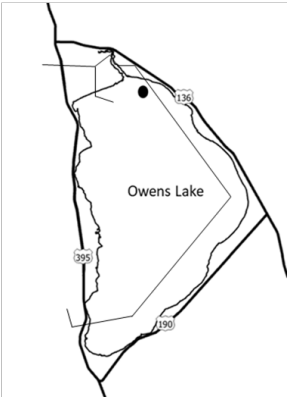
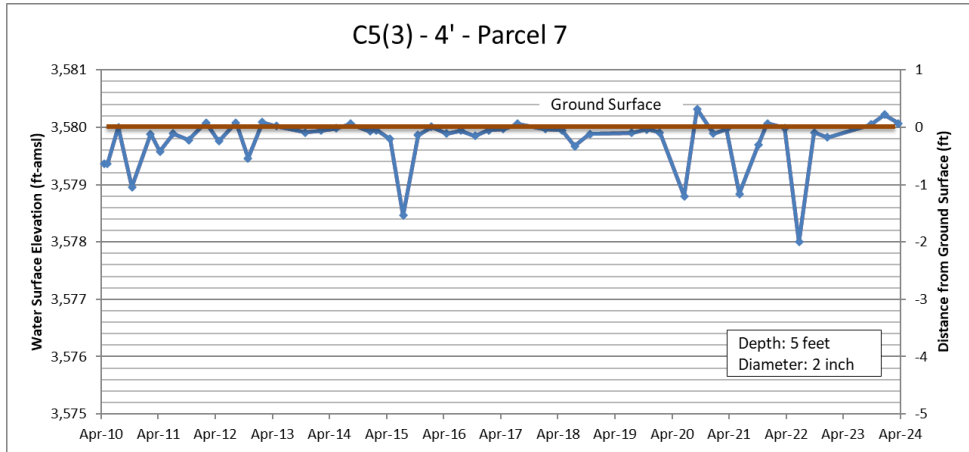
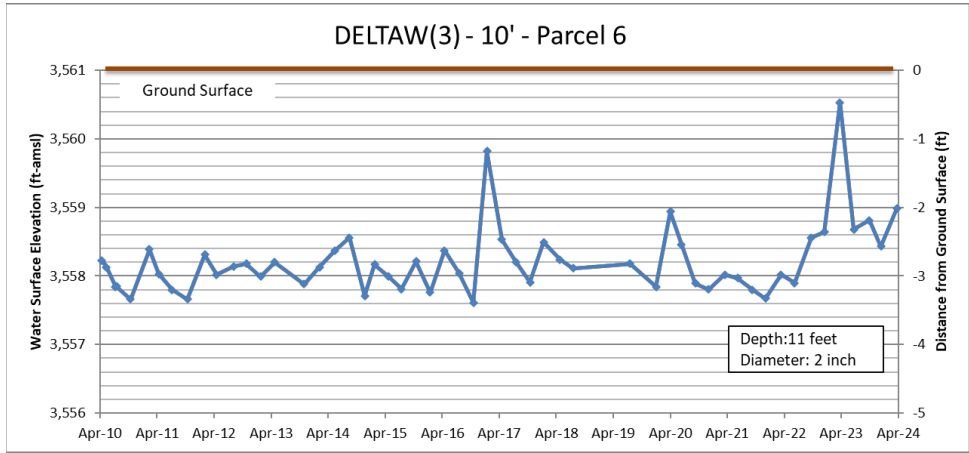
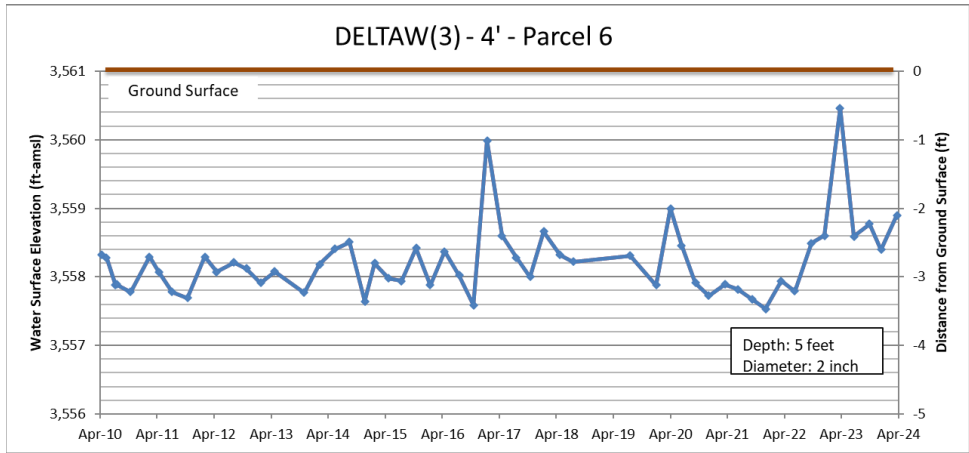

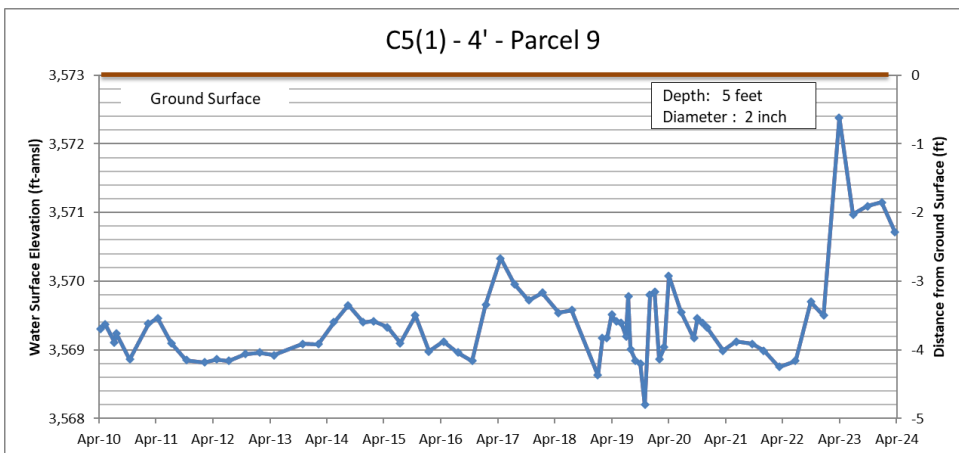
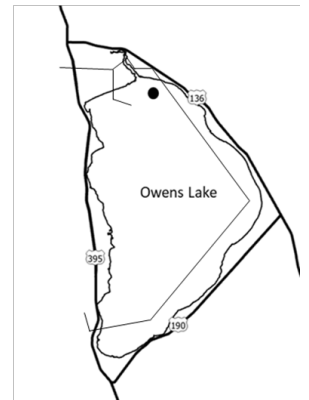
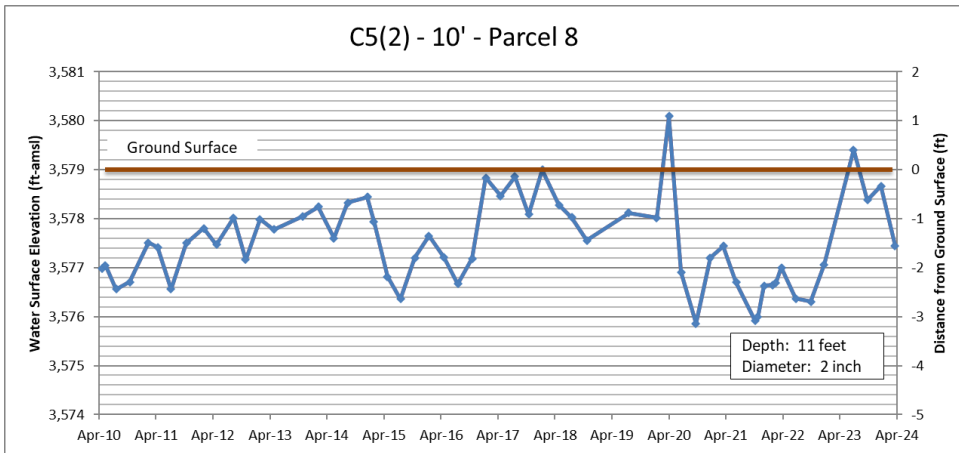
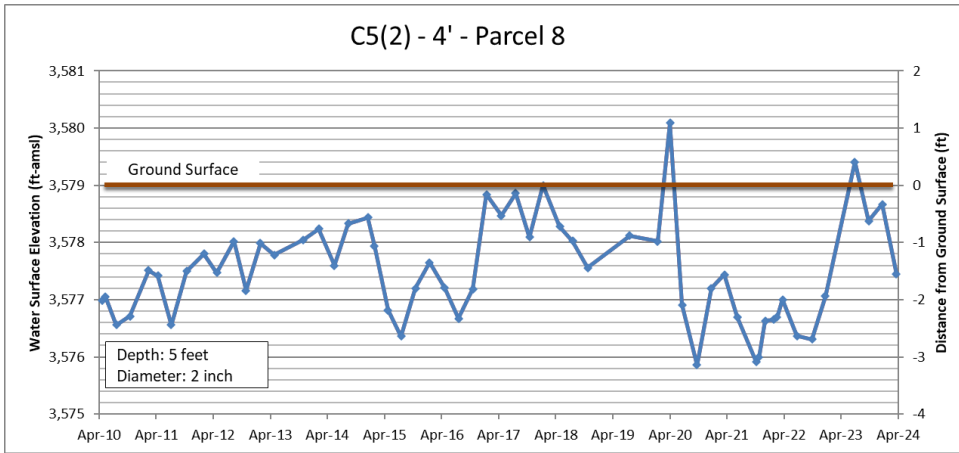

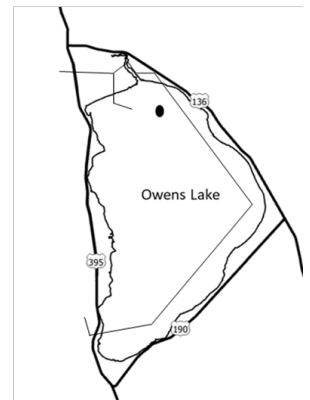
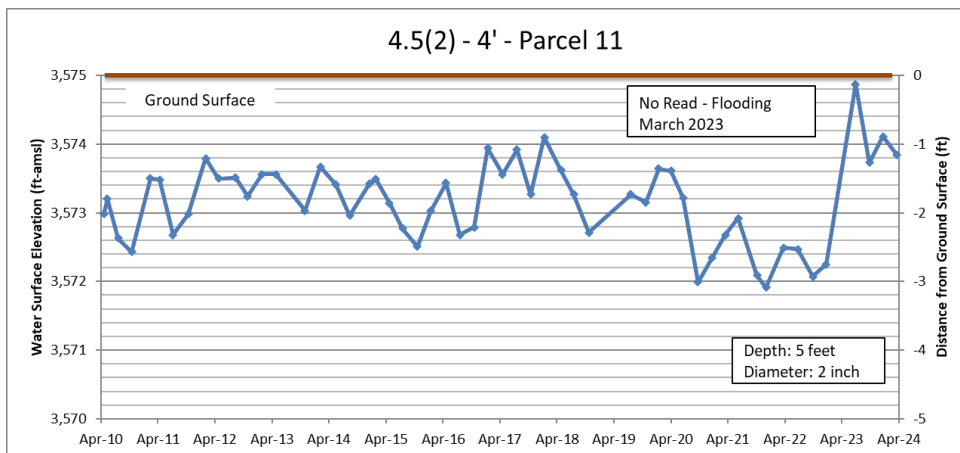
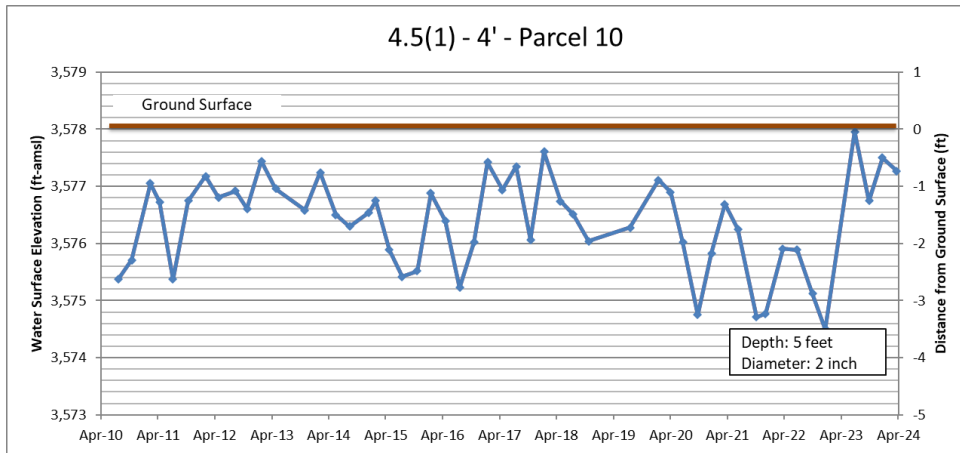
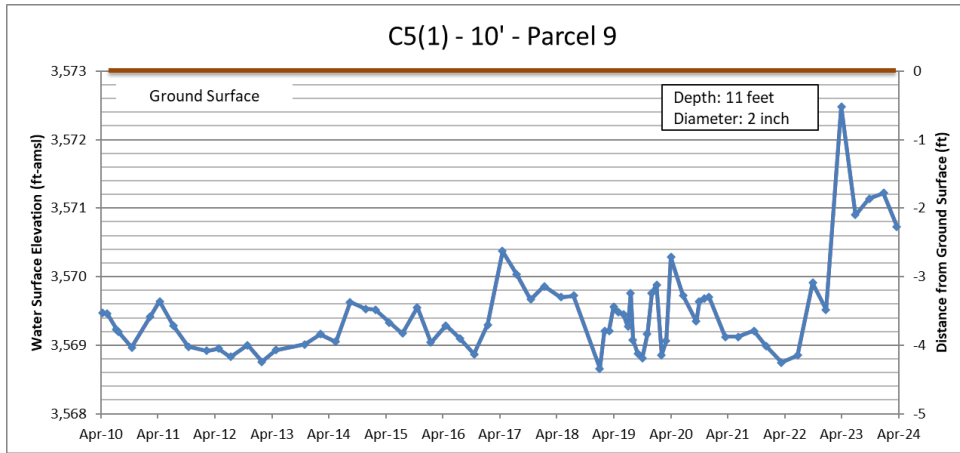

D.5(8) - 4' - Parcel 12

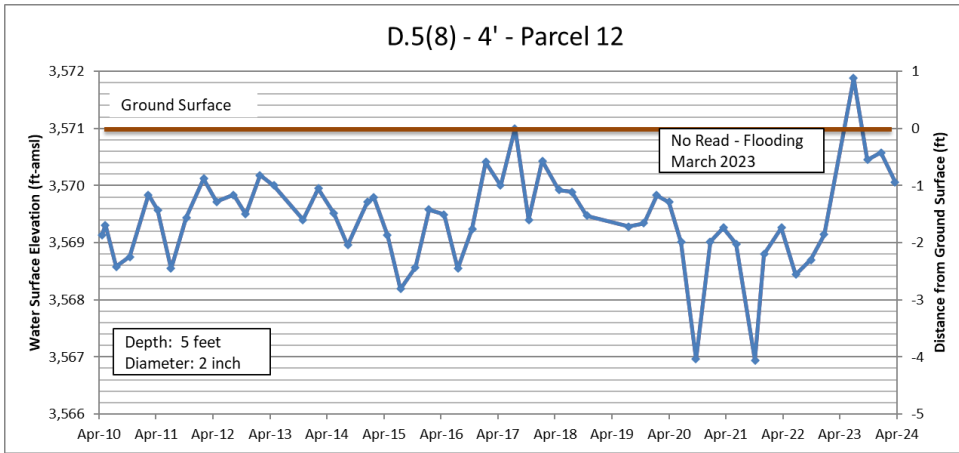

D.5(10) - 4' - Parcel 13

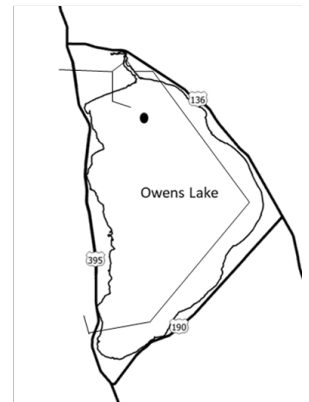
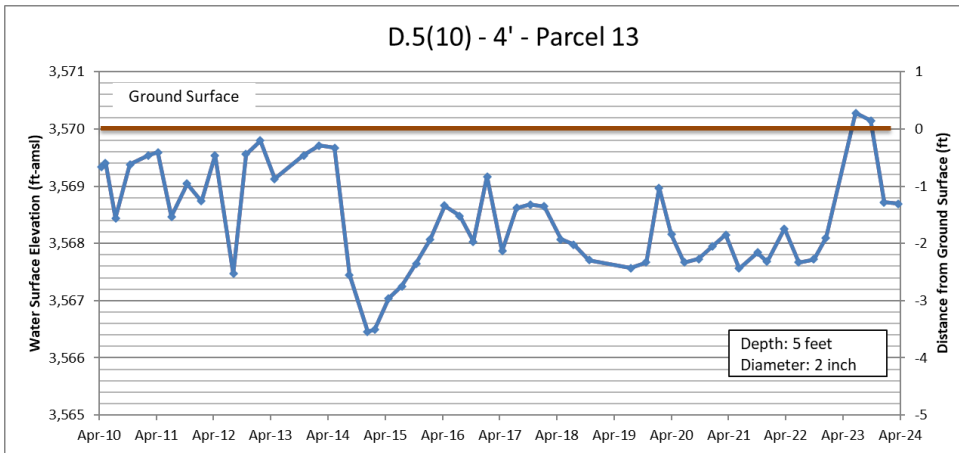

D.5(9) - 4' - Parcel 14

